

## SAFETY PRECAUTIONS

**!** Please follow these safety precautions in order to ensure proper installation and to prevent any bodily injuries and structural failures.

Please note that this unit includes poles and rods that are made out of steel, which can cause bodily injuries and/or damages to the floor if dropped or held in an improper manner during assembly.

1. This unit is designed for use by keeping the poles fixed to the floor and the ceiling. Therefore, it is not safe for children to climb or hang on the unit. Children should be under adult supervision at all times to prevent any injuries.

2. Overloading the unit might cause it to become unstable and either tip or collapse, which may cause serious bodily injury and/or damage to personal possessions.

3. In order to prevent any accidental collapses due to improper care, install the unit, so that it is slightly tilted towards the wall, not perpendicular to the floor.

4. We recommend that you frequently examine the unit for any loose bolts or wobbling.

### Please note

The unit may collapse if it is not securely fixed to the floor or if it is installed to a weak part of the ceiling.

### Differentiating Between the Poles

The upper poles are thinner than the lower poles. (Make sure the upper poles attach to the ceiling mount and lower poles to the floor mount during installation.)

### Inserting the Rods

Insert the rods tightly into the rod bracket. (The rods are designed to support a maximum load of 175lbs. Please do not exceed the allowable load limits.)

### Installing the Product in Areas with High Ceilings

Installation in areas with high ceilings may require a connecting pole (19.7 in.). Please contact customer service for more information.

### Role of the Rubber Ring

The rubber ring helps adjust the height of the fixtures and prevents them from slipping. The rubber rings should be inserted underneath each shelf bracket.

(The rubber rings inserted underneath the shelf brackets are not visible after installation.)

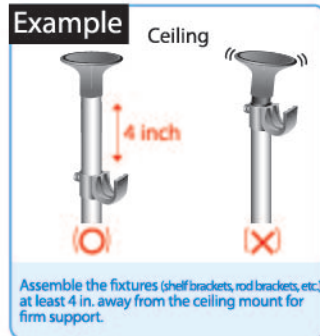

## THINGS TO DO BEFORE ASSEMBLY & DISASSEMBLY

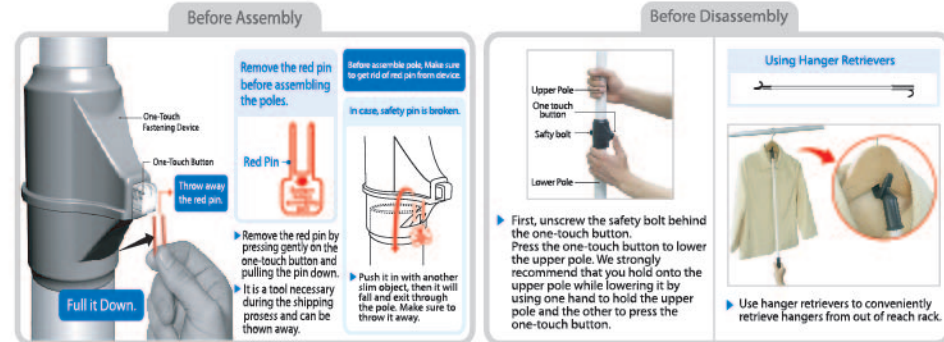

## SAFETY PRECAUTIONS

Product Components Check your inventory before beginning installation.

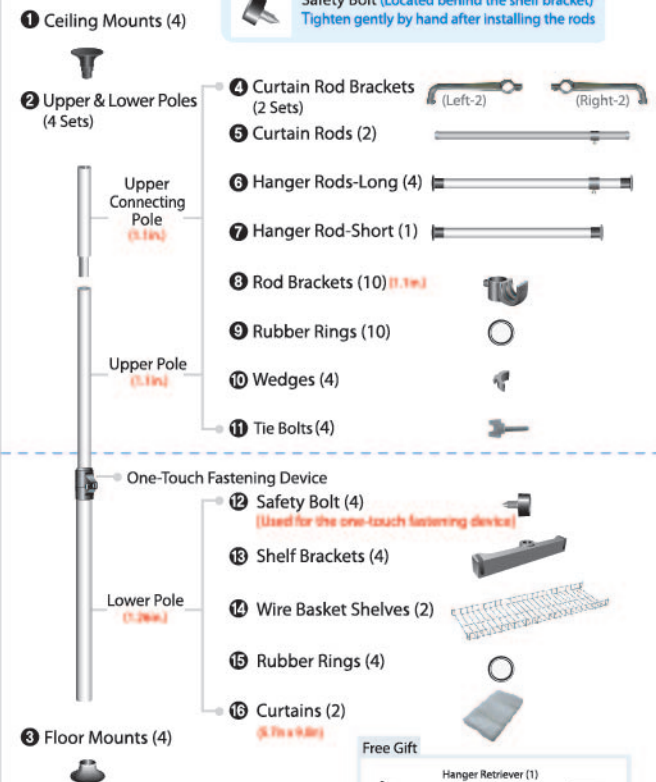

## FINISHED PRODUCT

\* Refer back to the diagram during installation as needed.

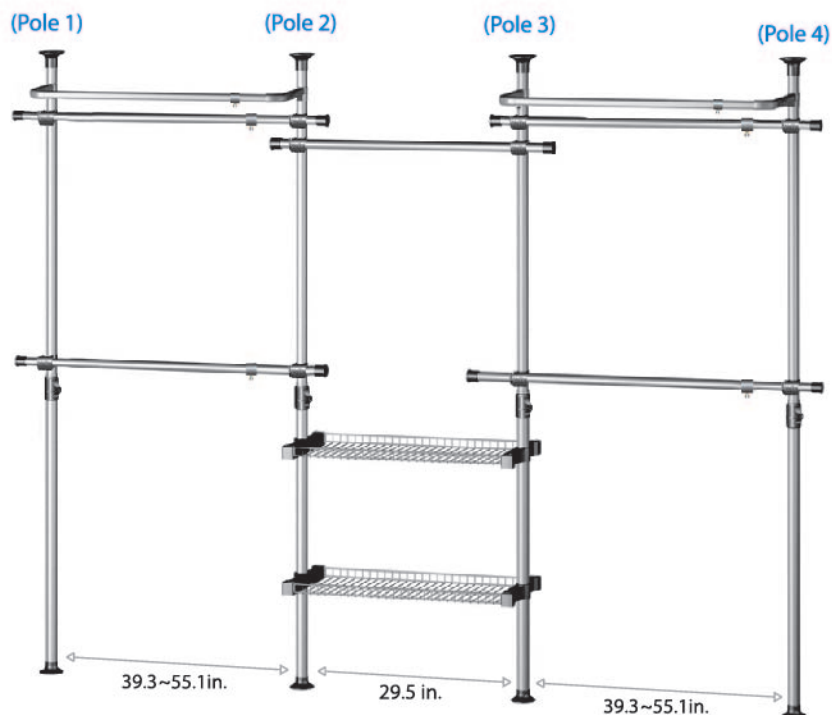

▲ \*Diagram of Product without Curtains

\*Product Dimensions:

Width: 127.7~159.3 in.

Depth: 22.4 in.

Height: 67~117 in.

Wire Basket Shelf: 29.5X11.8X1.4 in.

Curtains (Each): Width: 39.37 in. Length: 126 in. Depth: 8.86 in.

## ASSEMBLY INSTRUCTIONS (POLE)- 1

### Pole 1

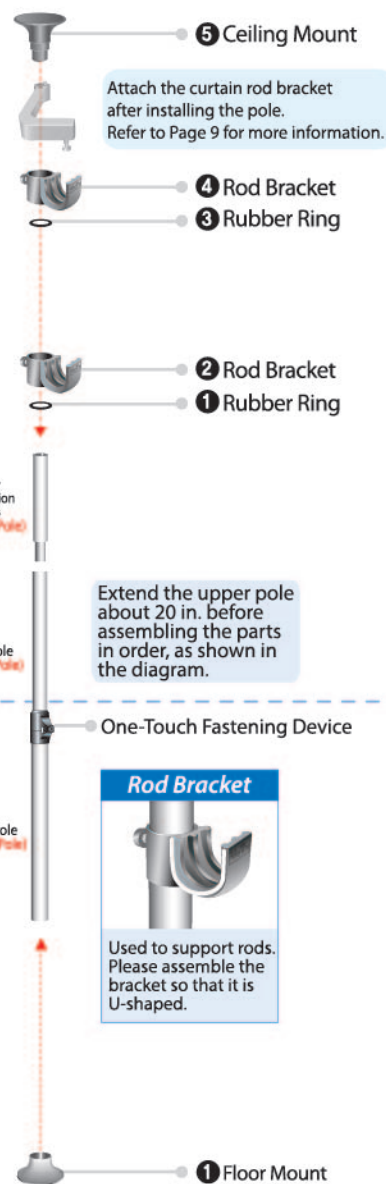

### Pole 2

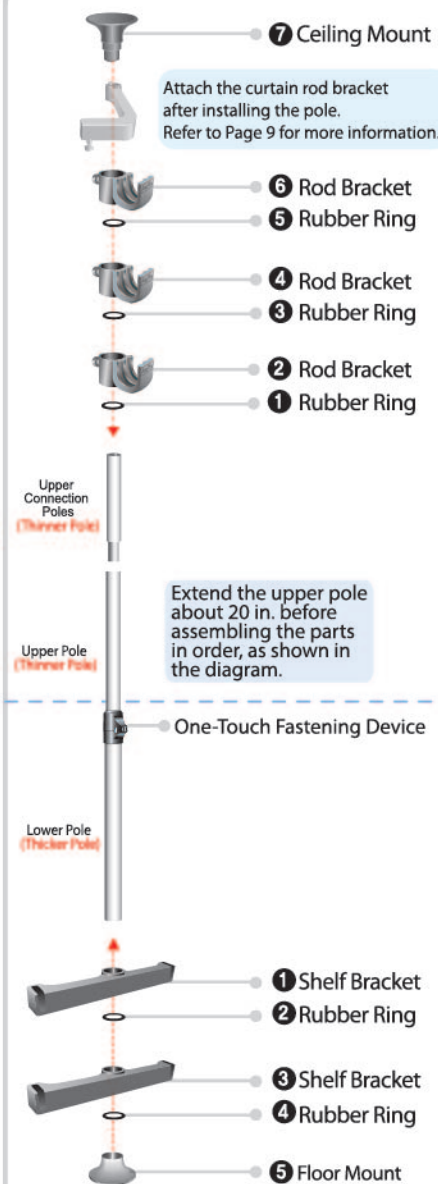



## ASSEMBLY INSTRUCTIONS (POLE)- 2

### Pole 3

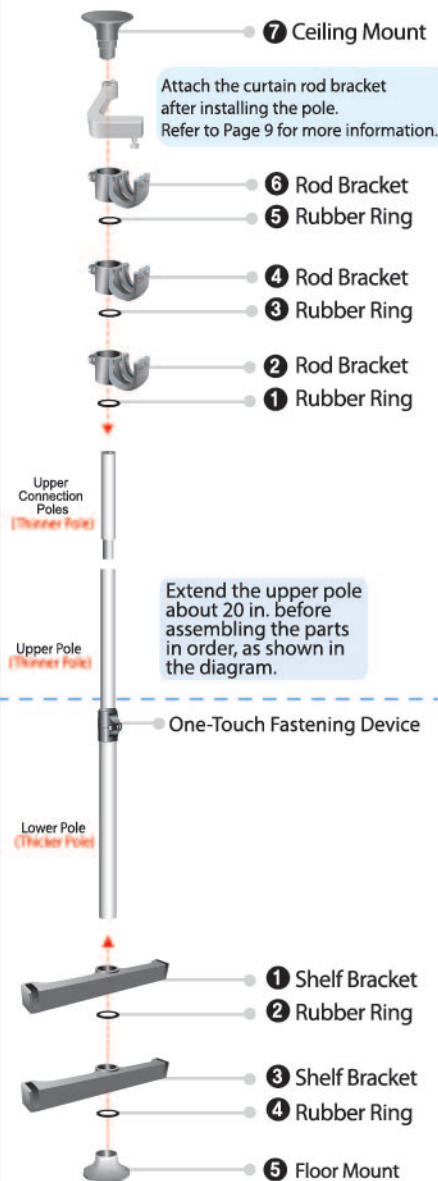

### Pole 4

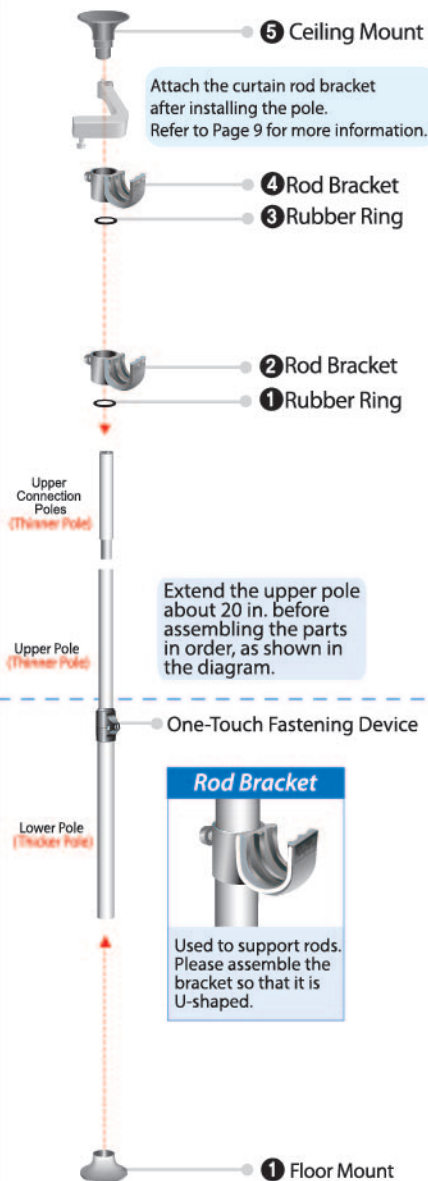

The rubber ring helps keep the fixtures in place and should be inserted underneath all of the fixtures. (The rubber rings inserted underneath the fixtures are not visible after installation.)

## INSTALLATION (POLE)

### To Install the Poles,

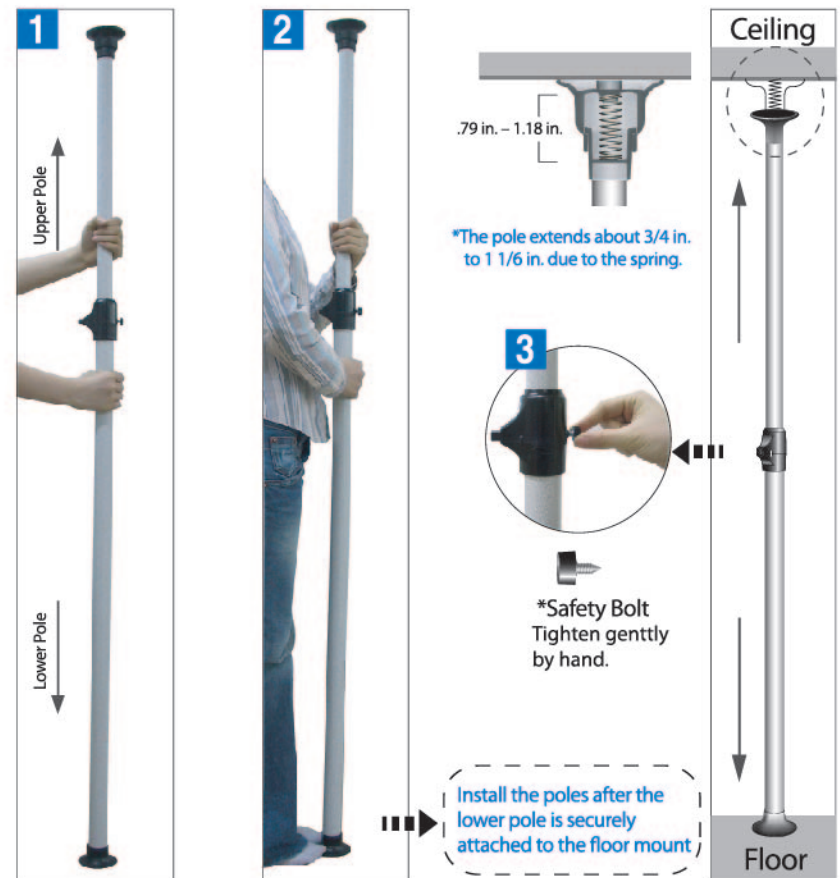

### Explanation

- At the desired location, hold the lower pole with one hand and the upper pole with the other and push it up to the ceiling so that the pole is fixed upright to both the ceiling and the floor. Make sure the pole is fixed securely on the ceiling by pushing the pole up as far as you can (which can extend up to 1 1/6 in. due to the spring mechanism in the ceiling mount).
- After installing the pole, tighten the safety bolt behind the one-touch fastening device by hand for safer use of the unit.

## INSTALLATION (POLE & OTHER FIXTURES)

To install poles and other fixtures,

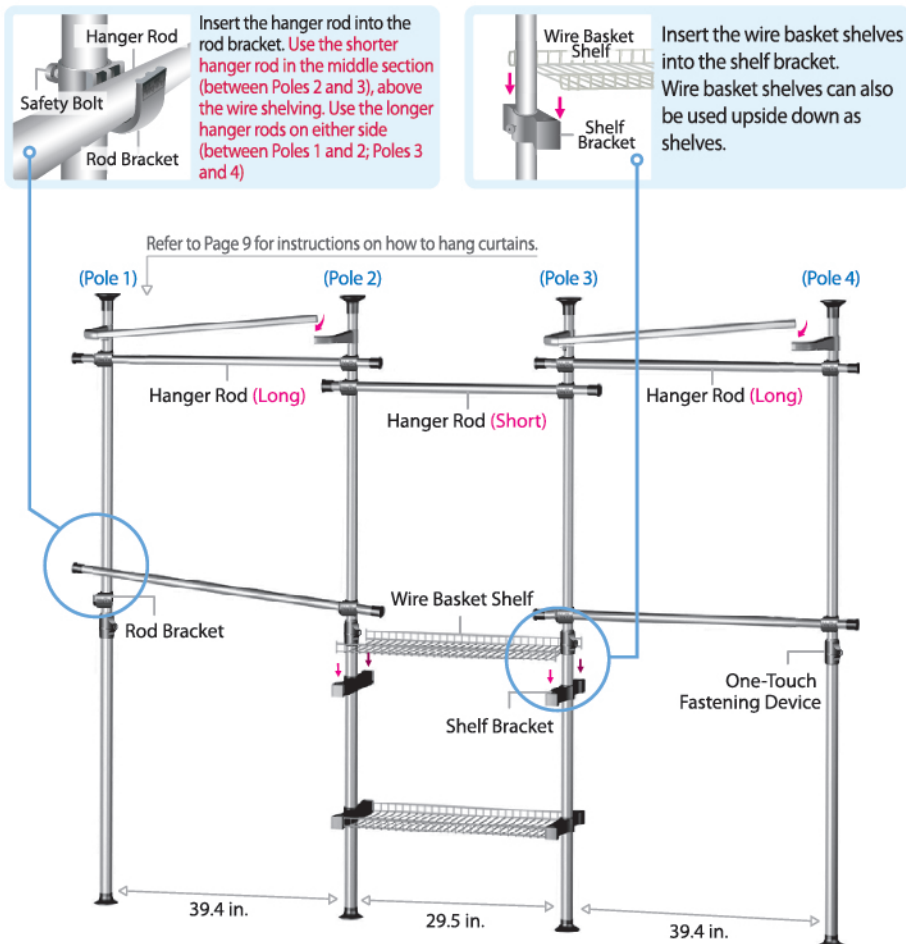

1. Set the poles upright and distance them apart to the desired width of the unit.
2. After keeping the rod brackets level, assemble the parts, as shown in the diagram.
3. Adjust the height of the rod bracket to the desired height using the rubber ring and then gently tighten the safety bolt in the back by hand.

## INSTALLATION (CURTAINS)

To Hang Curtains

### Installing Curtain Rod Brackets (1)

\*Important: Please insert the wedge.

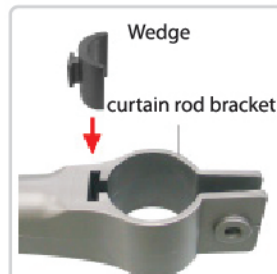

\*Tighten the tie bolt on the other side of the nut.

Left Side: With the Nut

Right Side: Without the Nut

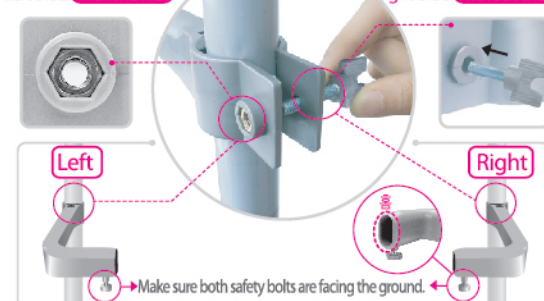

Keeping the curtain rod brackets level, attach them to the upper poles. Tighten the tie bolt on the other side of the nut. (The nut is only on one side of the bracket.)

### Installing Curtain Rod Brackets (2)

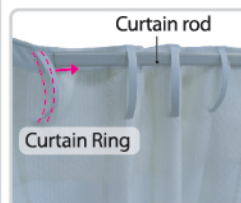

Identify the curtain rings on the top edge of the curtain. Thread the curtain rings through the curtain rod and put the rod into the brackets.

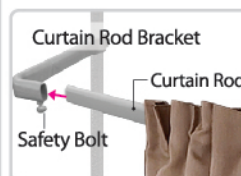

After mounting the curtain rod onto the rod bracket, tighten the safety bolt.

### Installing Curtain Rod Brackets (3)

\*Diagram of the Curtain Rods

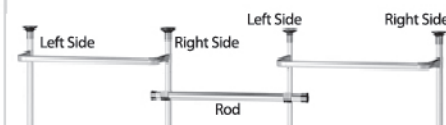

Finished Product

\*Image of the Curtain after Installation



Arrange curtains evenly.